

Series 17

Characteristics

The Series 17 indicator range comprises 6mm to 22.5mm components which are especially suited for:

- Raised design

The large variety of front designs facilitates combined use with other EAO series.

Functions

The Series 17 incorporates the following function:

- LED-Indicator

Market segments

The EAO Series 17 is especially suited for applications in the segments:

- Machinery and Automation
- Panel building
- Laboratory and measuring equipment

Please refer to the EAO website to obtain detailed information regarding this series www.products.eao.com
Configure a product to your exact needs and request a quotation.



Overview**Raised design**

Indicator 6 mm	4
Indicator 8 mm	5
Indicator 14 mm	7
Indicator 16 mm	9
Indicator 22 mm	11

Accessories 12**Drawings** 14**Tecnical data** 15**Index** 16

17 Raised design

Indicator 6 mm LED 3 mm, IP 40



Product can differ from the current configuration.

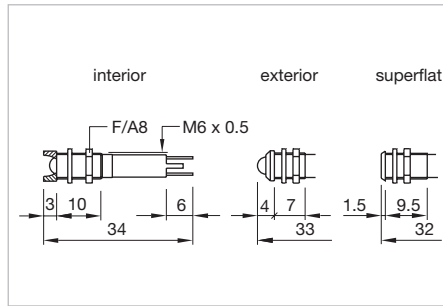

Dimensions [mm]

Equipment consisting of (schematic overview)

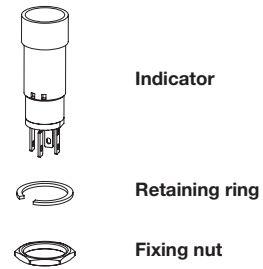



Each Part Number listed below includes all the black components shown in the 3D-drawing.

Additional Information

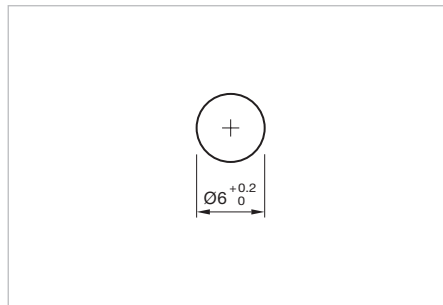
- Connectors: Brass terminal = anode (+); brass tinned terminal = cathode (-)
- Operating voltage tolerance +10 %
- Operating current tolerance ±15 %



Mounting cut-outs [mm]

Reflector	LED colour	Operating voltage	Operation current	Lumi. intensity	Terminal	Part No.	Weight
 <p>Indicator 6 mm LED 3 mm, Front dimension Ø 7 mm</p>							
Metal satin-chrome, interior	red	24 VDC	15 mA	8 mcd	Plug 2.0 x 0.5 mm	17-030350	0.003 kg
	green	24 VDC	15 mA	6 mcd	Plug 2.0 x 0.5 mm	17-030351	0.003 kg
	yellow	24 VDC	15 mA	6 mcd	Plug 2.0 x 0.5 mm	17-030352	0.003 kg
	green/yellow	24 VDC	15 mA	30/15 mcd	Plug 2.0 x 0.5 mm	17-030356	0.003 kg
	blue	24 VDC	15 mA	26 mcd	Plug 2.0 x 0.5 mm	17-030357	0.003 kg
	white	24 VDC	15 mA	410 mcd	Plug 2.0 x 0.5 mm	17-03035W	0.003 kg
 <p>Indicator 6 mm LED 3 mm, Front dimension Ø 7 mm</p>							
Metal satin-chrome, exterior	red	24 VDC	15 mA	8 mcd	Plug 2.0 x 0.5 mm	17-020350	0.003 kg
	green	24 VDC	15 mA	6 mcd	Plug 2.0 x 0.5 mm	17-020351	0.003 kg
	yellow	24 VDC	15 mA	6 mcd	Plug 2.0 x 0.5 mm	17-020352	0.003 kg
	white	24 VDC	15 mA	410 mcd	Plug 2.0 x 0.5 mm	17-02035W	0.003 kg
 <p>Indicator 6 mm LED 3 mm, Front dimension Ø 7 mm</p>							
Metal satin-chrome, superflat	red	24 VDC	15 mA	8 mcd	Plug 2.0 x 0.5 mm	17-000350	0.003 kg
	green	24 VDC	15 mA	6 mcd	Plug 2.0 x 0.5 mm	17-000351	0.003 kg
	yellow	24 VDC	15 mA	6 mcd	Plug 2.0 x 0.5 mm	17-000352	0.003 kg

Indicator 8 mm LED 5 mm, IP 67

Equipment consisting of (schematic overview)

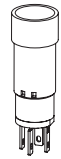

Indicator



Retaining ring



Fixing nut

Each Part Number listed below includes all the black components shown in the 3D-drawing.

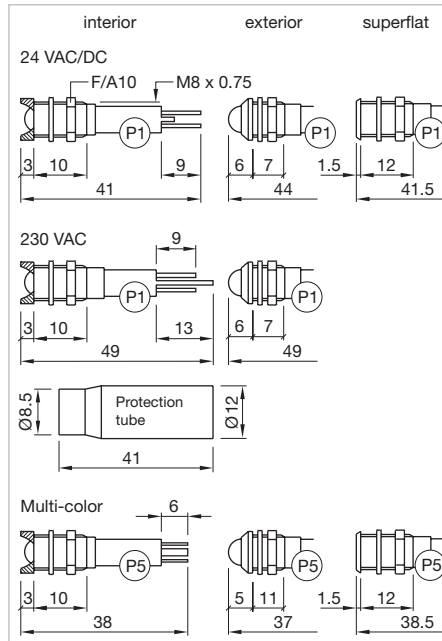

Dimensions [mm]
 P1 = Plug-in terminal 2.8 x 0.8 mm,
 P5 = Plug-in terminal 2.0 x 0.5 mm

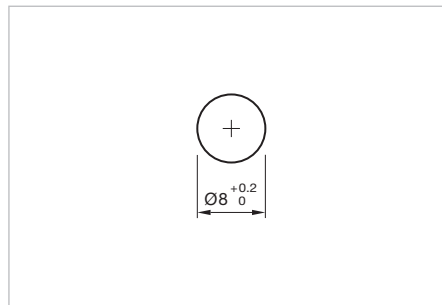

Mounting cut-outs [mm]



Product can differ from the current configuration.

Additional Information

- Connectors: Brass terminal = anode (+); brass tinned terminal = cathode (-)
- Operating voltage tolerance +10 %
- Operating current tolerance ±15 %

Product attribute	Reflector	LED colour	Operating voltage	Operation current	Lumi. intensity	Terminal	Part No.	Component layout	Weight
 <p>Indicator 8 mm LED 5 mm, Front dimension Ø 9.5 mm</p>	Metal satin-chrome, interior	red	24 VDC	20 mA	80 mcd	Plug 2.8 x 0.8 mm	17-050350		0.005 kg
			24 VAC	19 mA	76 mcd	Plug 2.8 x 0.8 mm	17-050360		0.005 kg
		green	24 VDC	20 mA	32 mcd	Plug 2.8 x 0.8 mm	17-050351		0.005 kg
			24 VAC	20 mA	30 mcd	Plug 2.8 x 0.8 mm	17-050361		0.005 kg
		yellow	24 VDC	20 mA	32 mcd	Plug 2.8 x 0.8 mm	17-050352		0.005 kg
			24 VAC	19 mA	30 mcd	Plug 2.8 x 0.8 mm	17-050362		0.005 kg
		blue	24 VDC	20 mA	60 mcd	Plug 2.8 x 0.8 mm	17-050357		0.005 kg
			24 VAC	19 mA	57 mcd	Plug 2.8 x 0.8 mm	17-050367		0.005 kg
		red/green	24 VDC	22 mA	11/30 mcd	Plug 2.0 x 0.5 mm	17-130354	1	0.005 kg
		red/yellow	24 VDC	22 mA	10/11 mcd	Plug 2.0 x 0.5 mm	17-130355	2	0.005 kg
		green/yellow	24 VDC	22 mA	20/15 mcd	Plug 2.0 x 0.5 mm	17-130356	3	0.005 kg

17 Raised design

Product attribute	Reflector	LED colour	Operating voltage	Operation current	Lumi. intensity	Terminal	Part No.	Component layout	Weight
 <p>Indicator 8 mm LED 5 mm, Front dimension Ø 9.5 mm</p>									
Sunlight visibility, light reduction of around 25 % by use of AC	Metal satin-chrome, interior	red	24 VAC/DC	9/17 mA	1200 mcd	Plug 2.8 x 0.8 mm	17-090350		0.005 kg
		yellow	24 VAC/DC	9/17 mA	1100 mcd	Plug 2.8 x 0.8 mm	17-090352		0.005 kg
		green	24 VAC/DC	9/17 mA	1300 mcd	Plug 2.8 x 0.8 mm	17-090355		0.005 kg
		blue	24 VAC/DC	9/17 mA	600 mcd	Plug 2.8 x 0.8 mm	17-090357		0.005 kg
		white	24 VAC/DC	9/17 mA	1000 mcd	Plug 2.8 x 0.8 mm	17-09035W		0.005 kg
with protection tube	Metal satin-chrome, interior	red	230 VAC	3 mA	22 mcd	Plug 2.8 x 0.8 mm	17-500430		0.005 kg
		green	230 VAC	3 mA	5 mcd	Plug 2.8 x 0.8 mm	17-500431		0.005 kg
		yellow	230 VAC	3 mA	7 mcd	Plug 2.8 x 0.8 mm	17-500432		0.005 kg
	Metal black-chrome, interior	red	24 VDC	20 mA	80 mcd	Plug 2.8 x 0.8 mm	17-051350		0.005 kg
		green	24 VDC	20 mA	32 mcd	Plug 2.8 x 0.8 mm	17-051351		0.005 kg
		yellow	24 VDC	20 mA	32 mcd	Plug 2.8 x 0.8 mm	17-051352		0.005 kg
		blue	24 VDC	20 mA	60 mcd	Plug 2.8 x 0.8 mm	17-051357		0.005 kg
 <p>Indicator 8 mm LED 5 mm, Front dimension Ø 9.5 mm</p>									
	Metal satin-chrome, exterior	red	24 VDC	20 mA	80 mcd	Plug 2.8 x 0.8 mm	17-040350		0.005 kg
			24 VAC	19 mA	76 mcd	Plug 2.8 x 0.8 mm	17-040360		0.005 kg
		green	24 VDC	20 mA	32 mcd	Plug 2.8 x 0.8 mm	17-040351		0.005 kg
			24 VAC	19 mA	30 mcd	Plug 2.8 x 0.8 mm	17-040361		0.005 kg
		yellow	24 VDC	20 mA	32 mcd	Plug 2.8 x 0.8 mm	17-040352		0.005 kg
			24 VAC	19 mA	30 mcd	Plug 2.8 x 0.8 mm	17-040362		0.005 kg
		blue	24 VDC	20 mA	60 mcd	Plug 2.8 x 0.8 mm	17-040357		0.005 kg
			24 VAC	19 mA	57 mcd	Plug 2.8 x 0.8 mm	17-040367		0.005 kg
		red/green	24 VDC	22 mA	11/30 mcd	Plug 2.0 x 0.5 mm	17-120354	1	0.005 kg
		red/yellow	24 VDC	22 mA	10/11 mcd	Plug 2.0 x 0.5 mm	17-120355	2	0.005 kg
green/yellow	24 VDC	22 mA	20/15 mcd	Plug 2.0 x 0.5 mm	17-120356	3	0.005 kg		
Sunlight visibility, light reduction of around 25 % by use of AC	Metal satin-chrome, exterior	red	24 VAC/DC	9/17 mA	1200 mcd	Plug 2.8 x 0.8 mm	17-080350		0.005 kg
		yellow	24 VAC/DC	9/17 mA	1100 mcd	Plug 2.8 x 0.8 mm	17-080352		0.005 kg
		green	24 VAC/DC	9/17 mA	1300 mcd	Plug 2.8 x 0.8 mm	17-080355		0.005 kg
		blue	24 VAC/DC	9/17 mA	600 mcd	Plug 2.8 x 0.8 mm	17-080357		0.005 kg
		white	24 VAC/DC	9/17 mA	1000 mcd	Plug 2.8 x 0.8 mm	17-08035W		0.005 kg
with protection tube	Metal satin-chrome, exterior	red	230 VAC	3 mA	22 mcd	Plug 2.8 x 0.8 mm	17-510430		0.006 kg
		green	230 VAC	3 mA	5 mcd	Plug 2.8 x 0.8 mm	17-510431		0.006 kg
		yellow	230 VAC	3 mA	7 mcd	Plug 2.8 x 0.8 mm	17-510432		0.006 kg
	Metal black-chrome, exterior	red	24 VDC	20 mA	80 mcd	Plug 2.8 x 0.8 mm	17-041350		0.005 kg
		green	24 VDC	20 mA	32 mcd	Plug 2.8 x 0.8 mm	17-041351		0.005 kg
		yellow	24 VDC	20 mA	32 mcd	Plug 2.8 x 0.8 mm	17-041352		0.005 kg
		blue	24 VDC	20 mA	60 mcd	Plug 2.8 x 0.8 mm	17-041357		0.005 kg
 <p>Indicator 8 mm LED 5 mm, Front dimension Ø 9.5 mm</p>									
	Metal satin-chrome, superflat	red	24 VDC	20 mA	13 mcd	Plug 2.8 x 0.8 mm	17-010350		0.005 kg
		green	24 VDC	20 mA	8 mcd	Plug 2.8 x 0.8 mm	17-010351		0.005 kg
		yellow	24 VDC	20 mA	8 mcd	Plug 2.8 x 0.8 mm	17-010352		0.005 kg
		red/green/yellow	24 VDC	15/15/3 mA	3/3/6 mcd	Plug 2.0 x 0.5 mm	17-100354	1	0.005 kg

The component layouts you will find from page 14

Indicator 14 mm, LED 10 mm, IP 67



Product can differ from the current configuration.

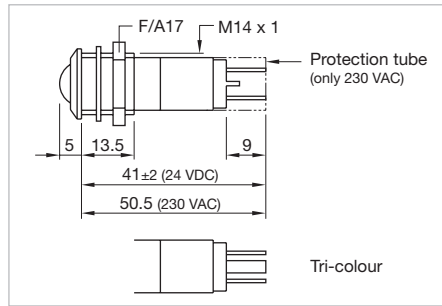

Dimensions [mm]

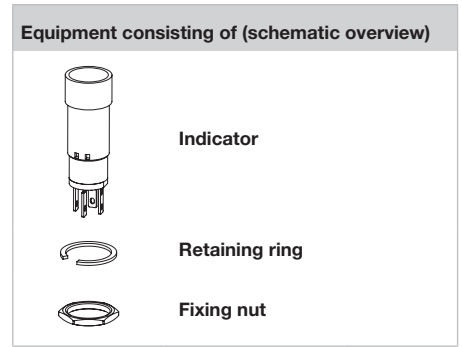

Additional Information

- Connectors: Brass terminal = anode (+); brass tinned terminal = cathode (-)
- Operating voltage tolerance +10 %
- Operating current tolerance ±15 %

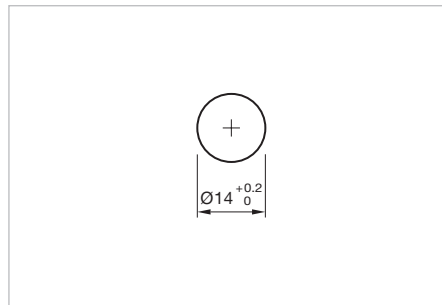

Mounting cut-outs [mm]

Each Part Number listed below includes all the black components shown in the 3D-drawing.

Product attribute	Reflector	LED colour	Operating voltage	Operation current	Lumi. intensity	Terminal	Part No.	Component layout	Weight	
<p>Indicator 14 mm, LED 10 mm, Front dimension Ø 16 mm</p>	Metal satin-chrome	red	24 VDC	20 mA	150 mcd	Plug 2.8 x 0.8mm	17-210350		0.014 kg	
		green	24 VDC	20 mA	70 mcd	Plug 2.8 x 0.8mm	17-210351		0.014 kg	
		yellow	24 VDC	20 mA	70 mcd	Plug 2.8 x 0.8mm	17-210352		0.014 kg	
	Metal black-chrome	red	24 VDC	20 mA	150 mcd	Plug 2.8 x 0.8mm	17-211350		0.014 kg	
		green	24 VDC	20 mA	70 mcd	Plug 2.8 x 0.8mm	17-211351		0.014 kg	
		yellow	24 VDC	20 mA	70 mcd	Plug 2.8 x 0.8mm	17-211352		0.014 kg	
	flashing	Metal satin-chrome	red	24 VDC	38 ... 56 mA	100 mcd	Plug 2.8 x 0.8mm	17-220350		0.014 kg
			green	24 VDC	38 ... 56 mA	70 mcd	Plug 2.8 x 0.8mm	17-220351		0.014 kg
			yellow	24 VDC	38 ... 56 mA	70 mcd	Plug 2.8 x 0.8mm	17-220352		0.014 kg
		Metal black-chrome	red	24 VDC	38 ... 56 mA	100 mcd	Plug 2.8 x 0.8mm	17-221350		0.014 kg
			green	24 VDC	38 ... 56 mA	70 mcd	Plug 2.8 x 0.8mm	17-221351		0.014 kg
			yellow	24 VDC	38 ... 56 mA	70 mcd	Plug 2.8 x 0.8mm	17-221352		0.014 kg
Tri-colour LED	Metal satin-chrome	red/green/yellow	24 VDC	20/20/20 mA	90/60/150 mcd	Plug 2.8 x 0.8mm	17-240354	1	0.014 kg	
Sunlight visibility, light reduction of around 25 % by use of AC	Metal satin-chrome	red	24 VAC/DC	9/17 mA	700 mcd	Plug 2.8 x 0.8mm	17-2A0350		0.014 kg	
		yellow	24 VAC/DC	9/17 mA	1000 mcd	Plug 2.8 x 0.8mm	17-2A0352		0.014 kg	
		green	24 VAC/DC	9/17 mA	1250 mcd	Plug 2.8 x 0.8mm	17-2A0355		0.014 kg	
		blue	24 VAC/DC	9/17 mA	500 mcd	Plug 2.8 x 0.8mm	17-2A0357		0.014 kg	
		white	24 VAC/DC	9/17 mA	1350 mcd	Plug 2.8 x 0.8mm	17-2A035W		0.014 kg	

17 Raised design

Product attribute	Reflector	LED colour	Operating voltage	Operation current	Lumi. intensity	Terminal	Part No.	Component layout	Weight
 <p>Indicator 14 mm, LED 10 mm, Front dimension Ø 16 mm</p>									
with protection tube	Metal satin-chrome	red	230 VAC	3 mA	18 mcd	Plug 2.8 x 0.8 mm	17-350230		0.015 kg
		green	230 VAC	3 mA	11 mcd	Plug 2.8 x 0.8 mm	17-350231		0.015 kg
		yellow	230 VAC	3 mA	8 mcd	Plug 2.8 x 0.8 mm	17-350233		0.015 kg
		red	230 VAC	3 mA	18 mcd	Plug 2.8 x 0.8 mm	17-351230		0.015 kg
		green	230 VAC	3 mA	11 mcd	Plug 2.8 x 0.8 mm	17-351231		0.015 kg
		yellow	230 VAC	3 mA	8 mcd	Plug 2.8 x 0.8 mm	17-351233		0.015 kg

The component layouts you will find from page 14

Indicator 16 mm LED 10 mm, IP 67



Product can differ from the current configuration.

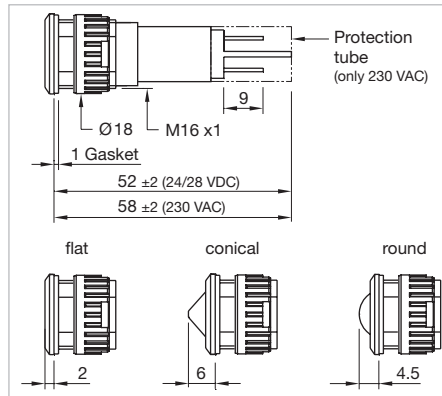

Dimensions [mm]

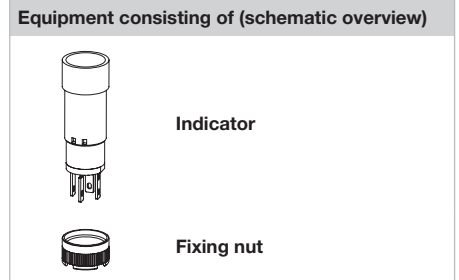

Each Part Number listed below includes all the black components shown in the 3D-drawing.

Additional Information

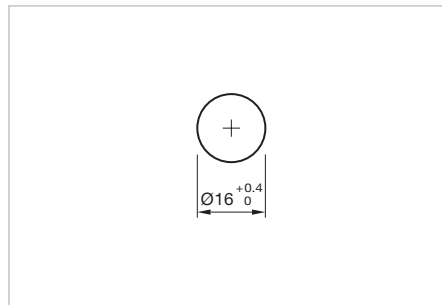

- Connectors: Brass terminal = anode (+); brass tinned terminal = cathode (-)
- Operating voltage tolerance +10 %
- Operating current tolerance ±15 %



Mounting cut-outs [mm]

Product attribute	Lens	Reflector	LED colour	Operating voltage	Operation current	Lumi. intensity	Terminal	Part No.	Weight
	flat	Pastic black	red	24 VDC	16 mA	870 mcd	Plug 2.8 x 0.8 mm	17-381350Z	0.007 kg
			green	24 VDC	15 mA	870 mcd	Plug 2.8 x 0.8 mm	17-381351Z	0.007 kg
			yellow	24 VDC	16 mA	1250 mcd	Plug 2.8 x 0.8 mm	17-381352Z	0.007 kg
			ultra-green	24 VDC	14 mA	4130 mcd	Plug 2.8 x 0.8 mm	17-381355Z	0.007 kg
			blue	24 VDC	14 mA	740 mcd	Plug 2.8 x 0.8 mm	17-381357Z	0.007 kg
			white	24 VDC	14 mA	1290 mcd	Plug 2.8 x 0.8 mm	17-38135WZ	0.007 kg
			with protection tube	flat	Pastic black	red	230 VAC	3 mA	140 mcd
green	230 VAC	3 mA				120 mcd	Plug 2.8 x 0.8 mm	17-411231Z	0.008 kg
yellow	230 VAC	3 mA				130 mcd	Plug 2.8 x 0.8 mm	17-411232Z	0.008 kg
ultra-green	230 VAC	3 mA				970 mcd	Plug 2.8 x 0.8 mm	17-411235Z	0.008 kg
blue	230 VAC	3 mA				150 mcd	Plug 2.8 x 0.8 mm	17-411237Z	0.008 kg
white	230 VAC	3 mA				280 mcd	Plug 2.8 x 0.8 mm	17-41123WZ	0.008 kg

17 Raised design

Product attribute	Lens	Reflector	LED colour	Operating voltage	Operation current	Lumi. intensity	Terminal	Part No.	Weight
 <p>Indicator 16 mm LED 10 mm, Front dimension Ø 18.3 mm</p>									
	conical	Pastic black	red	24 VDC	16 mA	1470 mcd	Plug 2.8 x 0.8 mm	17-391350Z	0.007 kg
			green	24 VDC	15 mA	820 mcd	Plug 2.8 x 0.8 mm	17-391351Z	0.007 kg
			yellow	24 VDC	16 mA	1640 mcd	Plug 2.8 x 0.8 mm	17-391352Z	0.007 kg
			ultra-green	24 VDC	14 mA	5030 mcd	Plug 2.8 x 0.8 mm	17-391355Z	0.007 kg
			blue	24 VDC	14 mA	860 mcd	Plug 2.8 x 0.8 mm	17-391357Z	0.007 kg
			white	24 VDC	14 mA	2760 mcd	Plug 2.8 x 0.8 mm	17-39135WZ	0.007 kg
with protection tube	conical	Pastic black	red	230 VAC	3 mA	240 mcd	Plug 2.8 x 0.8 mm	17-421230Z	0.008 kg
			green	230 VAC	3 mA	120 mcd	Plug 2.8 x 0.8 mm	17-421231Z	0.008 kg
			yellow	230 VAC	3 mA	190 mcd	Plug 2.8 x 0.8 mm	17-421232Z	0.008 kg
			ultra-green	230 VAC	3 mA	1280 mcd	Plug 2.8 x 0.8 mm	17-421235Z	0.008 kg
			blue	230 VAC	3 mA	200 mcd	Plug 2.8 x 0.8 mm	17-421237Z	0.008 kg
			white	230 VAC	3 mA	500 mcd	Plug 2.8 x 0.8 mm	17-42123WZ	0.008 kg
 <p>Indicator 16 mm LED 10 mm, Front dimension Ø 18.3 mm</p>									
	round	Pastic black	red	24 VDC	16 mA	1200 mcd	Plug 2.8 x 0.8 mm	17-371350Z	0.007 kg
			green	24 VDC	15 mA	980 mcd	Plug 2.8 x 0.8 mm	17-371351Z	0.007 kg
			yellow	24 VDC	16 mA	1650 mcd	Plug 2.8 x 0.8 mm	17-371352Z	0.007 kg
			ultra-green	24 VDC	14 mA	5440 mcd	Plug 2.8 x 0.8 mm	17-371355Z	0.007 kg
			blue	24 VDC	14 mA	860 mcd	Plug 2.8 x 0.8 mm	17-371357Z	0.007 kg
			white	24 VDC	14 mA	2460 mcd	Plug 2.8 x 0.8 mm	17-37135WZ	0.007 kg
with protection tube	round	Pastic black	red	230 VAC	3 mA	240 mcd	Plug 2.8 x 0.8 mm	17-401230Z	0.008 kg
			green	230 VAC	3 mA	150 mcd	Plug 2.8 x 0.8 mm	17-401231Z	0.008 kg
			yellow	230 VAC	3 mA	210 mcd	Plug 2.8 x 0.8 mm	17-401232Z	0.008 kg
			ultra-green	230 VAC	3 mA	1560 mcd	Plug 2.8 x 0.8 mm	17-401235Z	0.008 kg
			blue	230 VAC	3 mA	200 mcd	Plug 2.8 x 0.8 mm	17-401237Z	0.008 kg
			white	230 VAC	3 mA	350 mcd	Plug 2.8 x 0.8 mm	17-40123WZ	0.008 kg

Indicator 22mm LED 15 mm, IP 67



Product can differ from the current configuration.

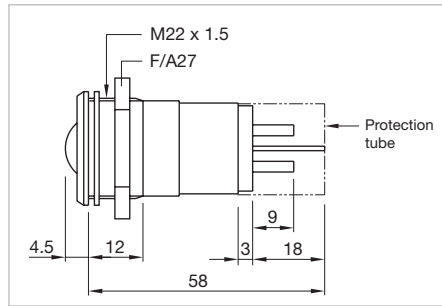

Dimensions [mm]

Equipment consisting of (schematic overview)

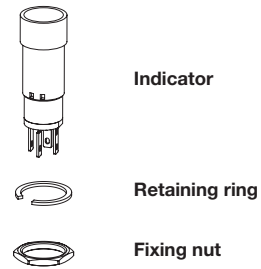

Each Part Number listed below includes all the black components shown in the 3D-drawing.

Additional Information

- Connectors: Brass terminal = anode (+); brass tinned terminal = cathode (-)
- Operating voltage tolerance +10 %
- Operating current tolerance ±15 %

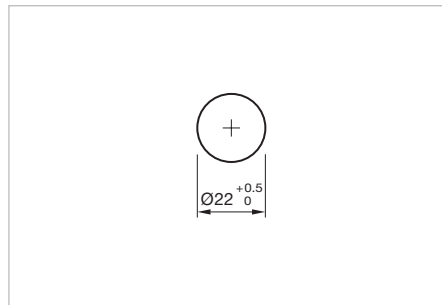

Mounting cut-outs [mm]

Product attribute	Reflector	LED colour	Operating voltage	Operation current	Lumi. intensity	Terminal	Part No.	Component layout	Weight
	Indicator 22mm LED 15 mm, Front dimension Ø 25 mm								
	Metal satin-chrome	red	24 VDC	19 mA	160 mcd	Plug 2.8 x 0.8 mm	17-530350	4	0.042 kg
		green	24 VDC	19 mA	120 mcd	Plug 2.8 x 0.8 mm	17-530351	4	0.042 kg
		yellow	24 VDC	19 mA	350 mcd	Plug 2.8 x 0.8 mm	17-530352	4	0.042 kg
		red/yellow/green	24 VDC	26/24/50 mA	51/92/120 mcd	Plug 2.8 x 0.8 mm	17-540354	5	0.042 kg
	Indicator 22mm LED 15 mm, Front dimension Ø 25 mm								
with protection tube	Metal satin-chrome	red	230 VAC	4 mA	28 mcd	Plug 2.8 x 0.8 mm	17-570230	4	0.044 kg
		green	230 VAC	4 mA	20 mcd	Plug 2.8 x 0.8 mm	17-570231	4	0.044 kg
		yellow	230 VAC	4 mA	48 mcd	Plug 2.8 x 0.8 mm	17-570232	4	0.044 kg

The component layouts you will find from page 14



17 Accessories

Backside

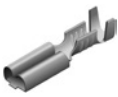
Flat receptacle

Product attribute	Part No.	Weight
 <p>Flat receptacle</p>		
2.0 x 0.5 mm plug-in terminal	31-945	0.001 kg
 <p>Flat receptacle</p>		
2.8 x 0.8 mm plug-in terminal	84-9420	0.001 kg

Insulation sleeve



Product attribute	Part No.	Weight
 <p>Insulation sleeve</p>		
for flat receptacle 2.0 mm	31-928	0.001 kg
 <p>Insulation sleeve</p>		
for flat receptacle 2.8 mm	31-929	0.001 kg

Mounting

Fixing nut long

Dimension	Part No.	Weight
 <p>Fixing nut long</p>		
Ø 9/M8 x 13 mm	19-991	0.001 kg

Mounting tool

Produkteigenschaften	Part No.	Weight
 <p>Mounting tool</p>		
	01-907	0.02 kg
 <p>Mounting tool</p>		
for fixing nut long Part No. 19-991	19-905	0.011 kg

17 Drawings

Drawings

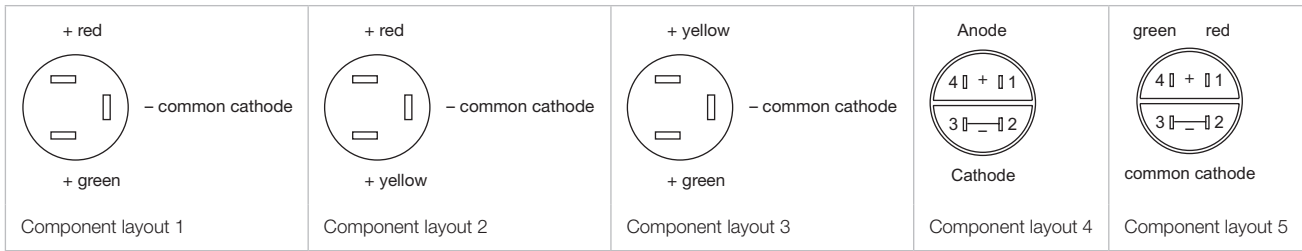

Technical Data
Material
Actuator

Reflector: Brass satin chrome/black chrome
 for indicator 16mm dia. in black plastic
 The plastic (polycarbonate) is limited resistant against chemicals

Mechanical characteristics
Terminals

Plug-in terminal 2.0 x 0.5 mm or 2.8 x 0.8 mm
 The indicators with tab-connection are not qualified for soldering

Tightening torque

20 Ncm

Electrical characteristics
Polarity

Anode (+) Brass plug-in connector
 Cathode (-) Brass tinned plug-in connector

Operating voltage tolerance

+10 %

Operating current tolerance

±15 %

Optical characteristics
Wave length

red	660 nm
super red	625 nm
hyper red	660 nm
orange	625 nm (for execution 230V: 610 nm)
green	565 nm
yellow/green	570 nm (for execution 230V: 575 nm)
yellow	590 nm
blue	475 nm
red/green	660/565 nm
red/yellow	660/590 nm

Environmental conditions
Storage temperature

-25 °C ... +80 °C

Service temperature

-20 °C ... +60 °C

Protection degree

front IP 40

IP 67 as per DIN EN 60529 - Gap between LED and reflector and gap between reflector and frontplate sealed to IP 67 when using the supplied gasket

Approvals
Approbations

UL
 VDE

EAO reserves the right to alter specifications without further notice.

17 Index

Index from Part No.

Part No.	Page	Part No.	Page
01-907	13	17-350231	8
17-000350	4	17-350233	8
17-000351	4	17-351230	8
17-000352	4	17-351231	8
17-010350	6	17-351233	8
17-010351	6	17-371350Z	10
17-010352	6	17-371351Z	10
17-020350	4	17-371352Z	10
17-020351	4	17-371355Z	10
17-020352	4	17-371357Z	10
17-02035W	4	17-37135WZ	10
17-030350	4	17-381350Z	9
17-030351	4	17-381351Z	9
17-030352	4	17-381352Z	9
17-030356	4	17-381355Z	9
17-030357	4	17-381357Z	9
17-03035W	4	17-38135WZ	9
17-040350	6	17-391350Z	10
17-040351	6	17-391351Z	10
17-040352	6	17-391352Z	10
17-040357	6	17-391355Z	10
17-040360	6	17-391357Z	10
17-040361	6	17-39135WZ	10
17-040362	6	17-401230Z	10
17-040367	6	17-401231Z	10
17-041350	6	17-401232Z	10
17-041351	6	17-401235Z	10
17-041352	6	17-401237Z	10
17-041357	6	17-40123WZ	10
17-050350	5	17-411230Z	9
17-050351	5	17-411231Z	9
17-050352	5	17-411232Z	9
17-050357	5	17-411235Z	9
17-050360	5	17-411237Z	9
17-050361	5	17-41123WZ	9
17-050362	5	17-421230Z	10
17-050367	5	17-421231Z	10
17-051350	6	17-421232Z	10
17-051351	6	17-421235Z	10
17-051352	6	17-421237Z	10
17-051357	6	17-42123WZ	10
17-080350	6	17-500430	6
17-080352	6	17-500431	6
17-080355	6	17-500432	6
17-080357	6	17-510430	6
17-08035W	6	17-510431	6
17-090350	6	17-510432	6
17-090352	6	17-530350	11
17-090355	6	17-530351	11
17-090357	6	17-530352	11
17-09035W	6	17-540354	11
17-100354	6	17-570230	11
17-120354	6	17-570231	11
17-120355	6	17-570232	11
17-120356	6	19-905	13
17-130354	5	19-991	13
17-130355	5	31-928	12
17-130356	5	31-929	12
17-210350	7	31-945	12
17-210351	7	84-9420	12
17-210352	7		
17-211350	7		
17-211351	7		
17-211352	7		
17-220350	7		
17-220351	7		
17-220352	7		
17-221350	7		
17-221351	7		
17-221352	7		
17-240354	7		
17-2A0350	7		
17-2A0352	7		
17-2A0355	7		
17-2A0357	7		
17-2A035W	7		
17-350230	8		

